

X-JET NOZZLE

Long Range External Chemical Injection

The Original X-Jet

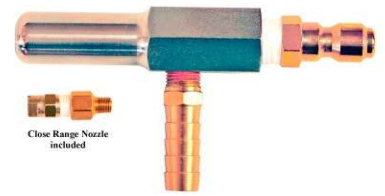

X-Jet M5



FEATURES

- Two versions to choose from.
 - Original X-Jet with fixed long and close range spray patterns
 - X-Jet M5 with Adjustable spray pattern from 5 to 60 degree spray pattern
- Apply soap & rinse with the same nozzle
- Projects chemicals up to 40ft or more depending on your machine
- NO chemicals run through the pump, hose, reels, gun, lance, or quick connects
- Color coded proportioners to apply chemicals at desired ratios

SPECIFICATIONS

| Style | The Original X-Jet (Fixed) | | | | | | X-Jet M5 (Adjustable) | | | | | |
|--------------------|---|---------------|---------------|---------------|---------------|---------------|---|---------------|---------------|---------------|---------------|---------------|
| Model | XJET-07K | XJET-09K | XJET-13K | XJET-16K | XJET-20K | XJET-25K | XJETM5-07K | XJETM5-09K | XJETM5-13K | XJETM5-16K | XJETM5-20K | XJETM5-25K |
| Operating Pressure | 2000-3000 PSI | 2000-3000 PSI | 2500-4000 PSI | 2500-4000 PSI | 2500-4000 PSI | 2500-4000 PSI | 2000-3000 PSI | 2000-3000 PSI | 2500-4000 PSI | 2500-4000 PSI | 2500-4000 PSI | 2500-4000 PSI |
| GPM Flow | 2 - 2.5 GPM | 3 - 3.5 GPM | 4 - 4.5 GPM | 5 - 6.5 GPM | 7 - 8 GPM | 8.5+ GPM | 2 - 2.5 GPM | 3 - 3.5 GPM | 4 - 4.5 GPM | 5 - 6.5 GPM | 7 - 8 GPM | 8.5+ GPM |
| Max Temperature | 190° F | | | | | | 190° F | | | | | |
| Port Sizes | Inlet 1/4" MPT x 1/4" QC Plug | | | | | | Inlet 1/4" MPT x 1/4" QC Plug | | | | | |
| | Chemical Port 1/8" MPT x 3/8" Hose Barb | | | | | | Chemical Port 1/8" MPT x 3/8" Hose Barb | | | | | |
| Kit Weight | 2.6 lbs | | | | | | 2.8 lbs | | | | | |

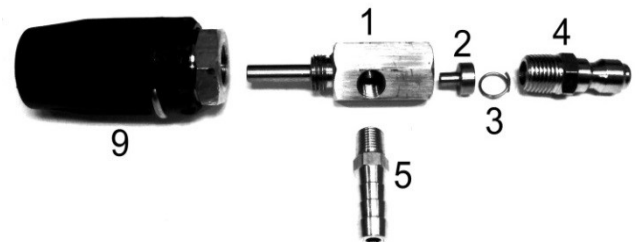
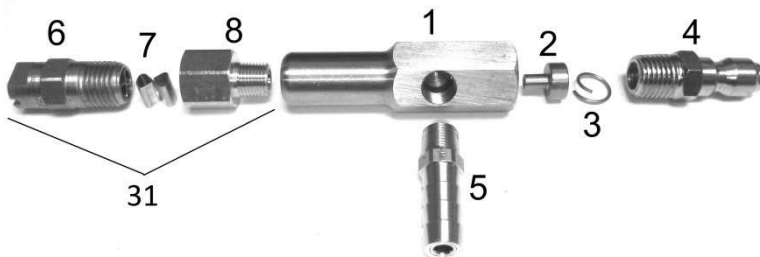

| Item | Part | Description |
|------|--------|---|
| 1 | N/A | X-Jet body-Not sold separately |
| *2 | OR(X) | Orifice (X is selected size 7,9,13,16,20,25 (See model number in chart above) |
| 3 | XSPR | Spring |
| 4 | XMP | 1/4" MPT x 1/4" Quick Connect Plug |
| 5 | XSHB | Chemical Hose Barb |
| 6 | XCRMN | Close Range Meg Nozzle |
| 7 | XCRNRV | Close Range Nozzle Vane |
| 8 | XCRNA | Close Range Nozzle Adapter |
| **9 | XM5RVN | Variable Nozzle (See note below) |
| 31 | XCRNAS | Close Range Nozzle Assembly (Items 6-8) |

*Special Order sizes available for machines larger than 8.5 GPM

**Replaceable; However, be advised variable nozzle is machined on to X-Jet body at factory for proper vertical fan orientation. With replacement by hand, orientation of spray pattern cannot be guaranteed.

| Item | Part | Description | Item | Part | Description |
|------|-----------|----------------------|------|--------------|---------------------|
| 10 | XJH | 3/8" Hose per ft | 20 | XPP-BLUE | Blue Proportioner |
| 11 | XSPDC | Clamps (2) | 21 | XPP-TAN(MED) | Tan Proportioner |
| 12 | XSOV | Shut Off Valve | 22 | XPP-GREEN | Green Proportioner |
| 13 | XBSHB | Hose Assembly Barb | 23 | XPP-ORANGE | Orange Proportioner |
| 14 | XBS | Ball Strainer Screen | 24 | XPP-BROWN | Brown Proportioner |
| 15 | XPP-GREY | Grey Proportioner | 25 | XPP-YELLOW | Yellow Proportioner |
| 16 | XPP-BLACK | Black Proportioner | 26 | XPP-AQUA | Aqua Proportioner |
| 17 | XPP-BEIGE | Beige Proportioner | 27 | XPP-PURPLE | Purple Proportioner |
| 18 | XPP-RED | Red Proportioner | 28 | XPP-PINK | Pink Proportioner |
| 19 | XPP-WHITE | White Proportioner | 29 | CLEAR | CLEAR NOT USED |



| | | |
|-----|-----------|---|
| Kit | XJET-XX | Original X-Jet Kit (Items 1-8, 30 & 32) XX is selected orifice size |
| Kit | XJETM5-XX | M5 X-Jet Kit (Items 1-5, 9, 30, & 32) XX is selected orifice size |
| 30 | XPP-PACK | Proportioner Pack (Items 15-29) |
| 31 | XCRNAS | Close Range Nozzle Assembly (Items 6-8) |
| 32 | XHA | Hose Assembly (Items 10-14) |



INSTALLATION

Read the instructions & warnings included with your X-Jet Kit in its entirety before installation. Determine the X-Jet model you need based on the operating pressure and GPM of your machine. Connect the X-Jet to the gun or lance via a 1/4" quick connect coupler (not included). Make sure it is properly connected before turning the pressure on. Always aim the nozzle away from all surfaces and people when first turning the pressure on to ensure the X-Jet is securely connected. Never aim the nozzle towards any person or animal in any circumstance. Always use the proper personal protective equipment when using the X-Jet Nozzle. Under no circumstances should the pressure of the pressure washer in use exceed the maximum rated pressure of any component.

TROUBLESHOOTING

| Problem | Cause | Solution |
|--|---|--|
| X-Jet will not draw chemical | Shut off valve in hose has failed Shut off valve is closed Incorrect orifice size Crack in chemical hose Debris is in barb or hose Pressure Washer is not working properly | Replace shut off valve Twist valve to open position Replace orifice with correct orifice size Replace chemical hose Clean debris out of hose or barb Verify proper operating pressure & GPM |
| Water is shooting out hose barb | Missing or Incorrect orifice size Debris is in orifice | Install or replace with correct size Clean debris out of orifice |
| Water stream is too misty | Incorrect orifice size Pressure Washer is not working properly | Replace orifice with correct orifice size Verify proper operating pressure & GPM |
| Water stream does not shoot far | Close range nozzle is attached to original X-Jet Incorrect Orifice Size Adjustable M5 nozzle is in closed position Pressure Washer is not working properly | Remove close range nozzle Replace orifice with correct orifice size Twist the adjustable nozzle to open Verify proper operating pressure & GPM |
| Questions ? X-Jet Technologies, Inc. 1-800-983-7467 | | |